

# **City of Billings Mountview Cemetery Products and Services**



**Mountview Cemetery  
1704 Central Ave.  
Billings, MT 59102  
406-657-8299**





## City of Billings Mountview Cemetery

The City of Billings Mountview Cemetery is the largest and oldest continually operated cemetery in the region. It includes the old Billings Cemetery that was run privately starting in approximately 1882. Many of the pioneers of the Billings area are buried here. Mountview Cemetery offers a variety of burial options to meet citizens' needs, including traditional casket burials and in-ground urn burials. Additionally, there are urn niche options both inside our mausoleum and in outdoor columbaria. We pride ourselves on our professional maintenance staff and attention to detail.

### Contact Information:

City of Billings Mountview Cemetery

1704 Central Ave

Billings, MT 59102

Office-406-657-8299

Supervisor Email:

Brandon Schmidt - [schmidt@billingsmt.gov](mailto:schmidt@billingsmt.gov)



## **Brochure Contents:**

- Cemetery Section Map P1
- Pricing and Definition Description P2
- Traditional Single Grave P3
- Two or More Traditional Graves P4
- Section 12 Graves P5
- Cremation Section Graves P6
- Green Burials P7
- Columbarium Urn Niches P8
- Simplicity Niches P9
- Mausoleum Bronze North and South Wall Niches P10
- Veteran's Graves P11
- Veteran's Niche P12

# Mountview Cemetery (Sections)

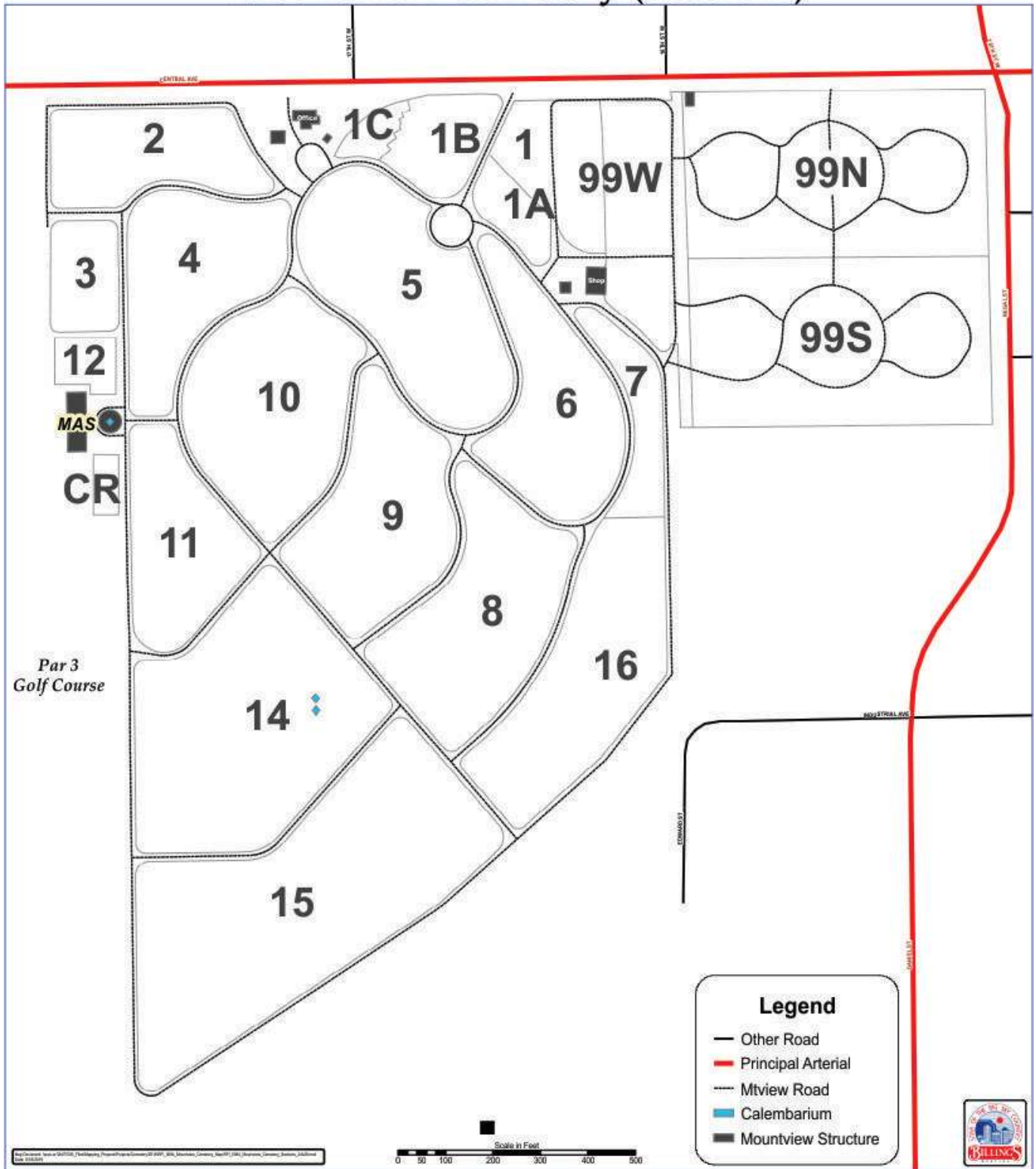



## Pricing Definitions and Descriptions:

Our goal at the Mountview Cemetery is to provide simple, convenient, and transparent pricing to the public. In order to achieve this goal, we typically only have two costs associated with a burial or inurnment. The first is the cost of the grave or niche. The second is the opening/closing cost for using the grave or niche. Each published price includes all associated services or fees. These costs are explained further in this section.

### Cost of Grave or Niche:

Graves and Niches can be purchased at any time prior to burial. When a grave or niche is purchased, the cemetery generates a record in our interment tracking system with information about the purchaser and the grave or niche's assigned users. Additionally, for pre-need graves or niches, Mountview Cemetery will issue a deed or certificate of ownership to the grave purchaser along with accompanying receipts and copies of the interment record. The fees and services included in the grave or niche price are as follows:

- *Perpetual Care*-Each grave or niche sold at the Mountview Cemetery has a 35% Perpetual Care charge included in the cost. This portion of the grave or niche cost is kept in a special fund that will be used to maintain the cemetery into perpetuity. The Perpetual Care charge is already included in the prices that are published in this brochure.
- *Flower Containers*-All grave prices include one (1) flush mount flower container. This flower container can be installed directly into the ground, or can be installed in the concrete border around a headstone. Not all niches have room for flower containers. Where available, a flower container will be listed as an optional add-on item to the cost of the niche.

### Opening/Closing Fee:

Opening/Closing fees are collected when an interment is scheduled. These fees cannot be paid in advance to the cemetery. We encourage individuals that wish to financially pre-plan for their funerals to visit with a funeral home. A Funeral Home Director has tools to collect the opening/closing fees in advance. Below is a list of items included in each opening/closing fee:

- *Casketed Burial Opening/Closing*- tent, four (4) chairs, greens, lowering device, casket cart, grave opening/closing.
- *Urn Burial Opening/Closing*- tent, four (4) chairs, greens, 2'x2' wooden podium, grave opening/closing.
- *Columbarium Niche Opening/Closing*- tent, four (4) chairs, niche opening/closing.
- *Mausoleum Crypt Opening/Closing*- four (4) chairs, casket cart, crypt opening/closing, casket lift & insertion.
- *Mausoleum Niche Opening/Closing*- four (4) chairs, 2'x2' wooden podium, niche opening/closing.



## Traditional Single Grave

A traditional single grave is the most common grave sold. The term *single grave* refers to the fact that the grave only has room for one casket. Despite that, a total of three people can be buried in a single grave. The grave can be used in the following configurations:

- One (1) casket and two (2) urns.
- Three (3) urns.

### Memorialization:

The disadvantage of a traditional single grave is that **only flat** monuments are allowed on a single grave. Each single grave has room for two (2) monuments total. There can be one (1) flat head stone (maximum size-2"x1"), and one (1) flat footstone (maximum size-2"x1"). Since there is only room for two monuments, but three people can be buried in a single grave, it is important to plan memorialization carefully in advance.

### Traditional Grave Price and Opening/Closing Fees:

	Weekday Casket Burial	Weekday Urn Burial	Saturday Casket Burial	Saturday Urn Burial
*Grave Cost	\$1,198	\$1,198	\$1,198	\$1,198
Casket Vault	\$1,210	---	\$1,210	---
Opening/Closing Fee	\$732	\$508	\$1,507	\$1,047.20
<b>**Total Costs:</b>	<b>\$3,140</b>	<b>\$1,706</b>	<b>\$3,915</b>	<b>\$2,245.2</b>

\*Grave Cost includes perpetual care and flower container (see pg. 2)

\*\*Any service after 3:00pm on a weekday or 2:00 pm on a Saturday will incur an overtime charge of \$435



Single traditional grave with headstone and footstone



Single traditional grave with headstone only

## Two or More Traditional Graves

It is necessary to purchase two or more adjacent grave for people who wish to be buried side by side in caskets. As with single graves, each grave can be used in the following configurations:

- One (1) casket and two (2) urns.
- Three (3) urns.

### Memorialization:

Upright monuments are allowed when centered over two (2) or more graves. This is one of the main advantages to buying multiple graves. Upright monuments must be placed at the head end of the graves. Additionally, each grave has room for one (1) flat footstone (maximum size-2"x1"). Please refer to the monument section of the brochure for additional information on upright monument sizes.

### Side by Side Grave Prices and Opening/Closing Fees for One Burial:

(The example in the pricing chart below shows the cost of two graves, but only one opening/closing fee for a casket or urn. Each additional grave is \$900 per grave.)

	<b>Weekday Casket Burial</b>	<b>Weekday Urn Burial</b>	<b>Saturday Casket Burial</b>	<b>Saturday Urn Burial</b>
*Grave Cost (two graves)	\$2,396	\$2,396	\$2,396	\$2,396
Casket Vault	\$1,210	---	\$1,210	---
Opening/Closing Fee for a Single Opening	\$732	\$508	\$1,507	\$1,047.20
<b>**Total Costs:</b>	<b>\$4,338</b>	<b>\$2,904</b>	<b>\$5,113</b>	<b>\$3,443.20</b>

\*Grave Cost includes perpetual care and flower container (see pg. 2)

\*\*Any service after 3:00pm on a weekday or 2:00pm on a Saturday will incur an overtime charge of \$435



Upright double headstone  
centered over two graves



Upright double headstone with  
footstone



Flat double headstone centered  
over two graves



## Section 12 Traditional Graves

Graves in section 12 are identical in size to other traditional graves. However, Section 12 is a newly developed section that has a small, intimate feel. Graves in Section 12 are close to internal roads and the Mausoleum. The section also has a tree-lined perimeter. Due to these factors, graves in Section 12 cost more. Opening/Closing fees are the same as traditional graves in other sections.

### Grave Configuration and Memorialization:

Traditional Graves in Section 12 adhere to the same standards and regulations that apply to other traditional graves throughout the cemetery. Please refer to the information found on page 2 and 3 for specific layout options.

### Section 12 Grave Price and Opening/Closing Fees:

	<b>Weekday Casket Burial</b>	<b>Weekday Urn Burial</b>	<b>Saturday Casket Burial</b>	<b>Saturday Urn Burial</b>
*Grave Cost	\$1,996	\$1,996	\$1,996	\$1,996
Casket Vault	\$1,210	---	\$1,210	---
Opening/Closing Fee	\$732	\$508	\$1,507	\$1,047.20
<b>**Total Costs:</b>	<b>\$3,938</b>	<b>\$2,504</b>	<b>\$4,713</b>	<b>\$3,043.20</b>

\*Grave Cost includes perpetual care and flower container (see pg. 2)

\*\*Any service after 3:00pm on a weekday or 2:00pm on a Saturday will incur an overtime charge of \$435



Upright marker in Section 12



## Cremation Section Graves

The Cremation graves were developed specifically for the burial of urns. Cremation graves are smaller. Depending on location, there is only room for one or two urns per grave. Due to the limited size, use of urns that are a standard size (14"x14") is encouraged.

### Memorialization:

Only one (1) flat marker per grave is allowed in the Cremation Section due to the size limitations. A shared marker may be installed over two or more graves. Below are the size guidelines for Cremation Section markers:

- Single marker maximum size- 8" x 16"
- Double marker maximum size- 12" x 24"
- Triple marker maximum size- 12" x 48"

For cremation graves not in the cremation section, traditional grave memorialization regulations apply (see pg. 4).

### Cremation Grave Price and Opening/Closing Fees:

	<b>Weekday Urn Burial</b>	<b>Weekend Urn Burial</b>
*Grave Cost	\$689	\$689
Opening/Closing Fee	\$508	\$1,047.20
<b>**Total Costs:</b>	<b>\$1,197</b>	<b>\$1,736.20</b>

\*Grave Cost includes perpetual care and flower container (see pg. 2)

\*\*Any service after 3:00pm on a weekday or 2:00pm on a Saturday will incur an overtime charge of \$435



Single headstone on one cremation grave



Double headstone centered over two cremation graves

## Green Burial

A green burial, also known as a natural burial, is an environmentally friendly alternative to traditional burial practices, focusing on sustainability and minimal environmental impact. In a green burial, the body is interred without embalming fluids, in a biodegradable coffin or shroud, allowing for natural decomposition. This practice emphasizes simplicity, conservation, and a return to the earth in a way that supports ecological balance. Since green burials are in a traditional plot, there can be one (1) green burial and two (2) urns per grave.

### Requirements:

- Mountview Cemetery requires a death certificate upon burial
- The deceased must be wrapped in a shroud or buried in a biodegradable casket (cardboard or wicker)
- A physician, physician designee, advanced practice registered nurse, coroner, or mortician must provide authorization that the deceased has not been embalmed
- Mountview Cemetery staff will not assist in transporting the deceased to the grave. The deceased must have a designated party to do so prior to their burial.

### Green Burial Price and Opening/Closing Fees:

	Weekday Green Burial	Saturday Green Burial
*Grave Cost	\$1,198	\$1,198
In Lieu of Vault	\$847	\$847
**Opening/Closing Fee	\$732	\$1,507
*** <b>Total Costs:</b>	<b>\$2,777</b>	<b>\$3,552</b>

\*Grave Cost includes perpetual care and flower container (see pg. 2)

\*\* If burial needs to occur within 24 hours, a charge of \$435 will apply to the Opening/Closing fees

\*\*\*Any service after 3:00pm on a weekday or 2:00pm on a Saturday will incur an overtime charge of \$435.



Green Burial

## Columbarium Niches

The columbarium is located in front of the Mausoleum. Niches in the columbarium have room for up to two (2) urns as long as the urns do not exceed 5 ½" x 5 ½" x 9" in size.

### Memorialization:

At the owner's expense, a monument company may engrave the niche front. Lettering must be skin frosted and highlighted with white lithichrome. If space is available, a fraternal organization or religious emblem may be included in the engraving. All other imagery is prohibited. With the exception of a flower container (see section below), other items or memorabilia may not be affixed to the surface of the niche.

### Flower Container:

Flower containers are available for an additional \$55, however, drilling a hole in the granite for the lug that supports the vase weakens the granite and is not recommended. Niche owners assume full liability for the flower container and installation.

### Columbarium Niche Price and Opening/Closing Fee:

	Row A (Bottom)	Row B	Row C	Row D (Top)
*Niche Cost	\$1,368	\$1,452	\$1,532	\$1,609
**Single Weekday Opening/Closing Fee	\$302.50	\$302.50	\$302.50	\$302.50
***Total Costs:	\$1670.50	\$1,754.50	\$1,834.50	\$1,911.50

\*Niche Cost includes perpetual care (see pg. 2)

\*\*Saturday Opening/Closing Fee \$387

\*\*\*Any service after 3:00pm on a weekday or 2:00pm on a Saturday will incur an overtime charge of \$435



Columbarium in front of the  
mausoleum



## Simplicity Niches

Simplicity Niches are located inside the mausoleum along the west wall immediately across from the entrance doors. These niches come in a variety of sizes.

### Memorialization:

In the glass fronted simplicity niches, memorialization can be done directly on the urn or with a name placard. Nameplate and inscription can be added to bronze niches. The cemetery will purchase nameplates to ensure uniformity. The cemetery will need to be reimbursed prior to the nameplate being attached.

### Vases:

Vases are available for an additional \$176.

### Simplicity Glass Front Niche Costs:

	Row A	Row B	Row C (10"x12 ¾"x 13 ½")	Row D- Bronze Front	Row E- Bronze Front
*Niche Cost	Unavailable	Unavailable	\$1,465	\$1,428	\$1,385

\*Niche Cost includes perpetual care, and business hour opening/closing fee. Saturday Opening/Closing Fee or After Hour Opening/Closing Fee is an additional \$435.



Simplicity Niches

## Bronze North and South Wall Niches

The bronze north and south wall niches are inside the entryway of the Mausoleum. They come in individual or companion sizes.

### Memorialization:

Nameplate and inscription can be added to bronze niches. The cemetery will purchase nameplates to ensure uniformity. The cemetery will need to be reimbursed prior to the nameplate being attached.

### Vases:

Unfortunately, the north and south wall niches do not have an option for vases.

### Single Niche Prices:

	<b>A &amp; N</b>	<b>B &amp; M</b>	<b>C &amp; L</b>	<b>D &amp; K</b>	<b>E-J</b>
*Niche Cost	\$823	\$853	\$896	\$932	\$980

### Companion Niche Prices:

	<b>B &amp; M</b>	<b>C &amp; L</b>	<b>D &amp; K</b>	<b>E-J</b>
*Niche Cost	\$1,319	\$1,391	\$1,458	\$1,537

\*Niche Cost includes perpetual care and business hour opening and closing fee.

Saturday Opening/Closing Fee or After-Hour Opening/Closing Fee is \$435.



Bronze Niches

## Veteran Grave

Mountview Cemetery has sections specifically established to honor Veterans. The current section open for Veterans' burial is Section 14. Veterans have the option of traditional casketed burial or urn burial in a traditional grave. The cost of the grave is free for Veterans. The costs charged to the Veteran are the opening/closing fee, curbing, vault (if required), and vase. Prior to burial, an application must be submitted to the cemetery to confirm military service dates and honorable discharge.

### Traditional Veteran Grave:

Veteran graves are assigned sequentially based on burial date. A spouse or family member's urn is allowed to be buried in the same grave as the Veteran, but the veteran must be interred first. **Please note that only a spouse may have their information inscribed on the back of a veteran's headstone.**

The grave can be used in the following configuration:

- One (1) casket and two (2) urns.
- Three (3) urns.

### Memorialization:

Only marble Veteran headstones are allowed in the Veteran section. Veteran headstones are provided by the Department of Veterans Affairs (VA). A VA headstone application is available at the Mountview Cemetery Office. If a spouse is buried in the same grave as the Veteran, they may have their name inscribed on the back of the headstone.

### Veteran Grave and Opening/Closing Fees:

	Weekday Casket Burial	Weekday Urn Burial	Saturday Casket Burial	Saturday Urn Burial
*Opening/Closing and Curbing Fee	\$2,281	\$847	\$3,056	\$1,386

\*Any service after 3:00pm on a weekday or 2:00pm on a Saturday will incur an overtime charge of \$435



Veteran's Grave



## Veteran Columbarium

In addition to traditional burials, Mountview Cemetery has a Veteran Columbarium located in Section 14. Columbarium niches are provided to the Veteran for free. The only cost associated with using the niche is the opening/closing.

### Veteran Columbarium Niche

Veterans niches are assigned sequentially based on burial date. A spouse's urn is allowed to share a niche with the Veteran. However, a spouse's information may not be inscribed on the niche face.

### Memorialization:

Niche inscriptions can be done by a local monument company. Inscriptions are done at the user's expense.

### Vases:

Vases are provided by the cemetery.

### Veteran Niche Opening/Closing Fees:

	<b>Weekday Fee</b>	<b>Saturday Fee</b>
*Columbarium Opening/Closing Fee	\$362.50	\$447

\*Any service after 3:00pm on a weekday or 2:00pm on a Saturday will incur an overtime charge of \$435



Veteran's Columbarium